

SIDE STEP COMPONENTS

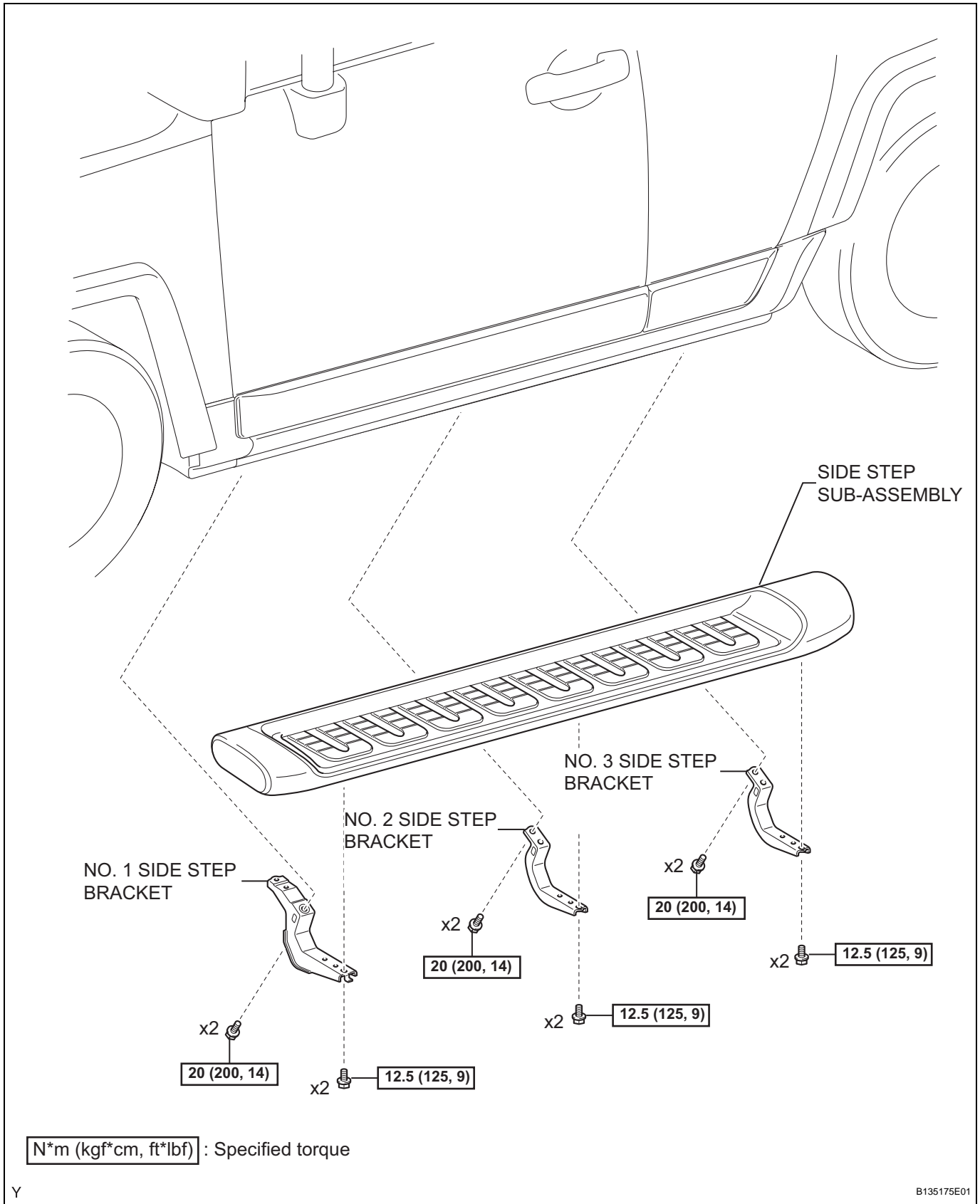

REMOVAL

HINT:

The procedure described below is for the LH side. Use the same procedure for both the RH and LH sides, unless otherwise specified.

1. REMOVE SIDE STEP SUB-ASSEMBLY

- (a) Remove the 6 bolts and the side step.

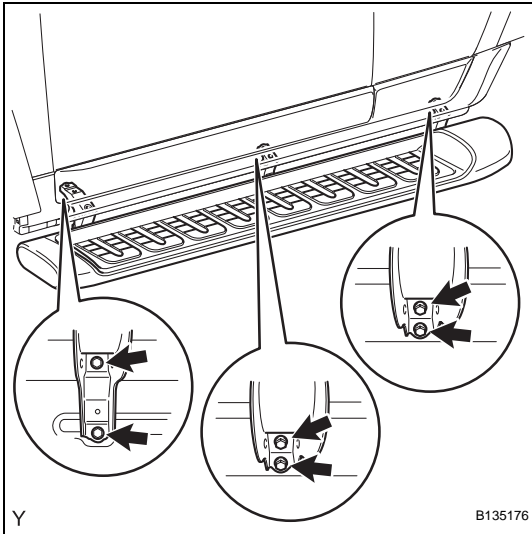

2. REMOVE NO. 1 SIDE STEP BRACKET

- (a) Remove the 2 bolts and the No. 1 side step bracket.

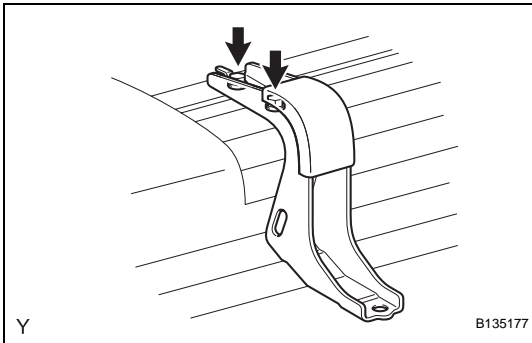

3. REMOVE NO. 2 SIDE STEP BRACKET

- (a) Remove the 2 bolts and the No. 2 side step bracket.

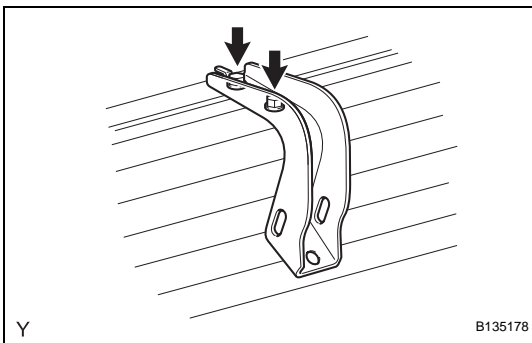

4. REMOVE NO. 3 SIDE STEP BRACKET

- (a) Remove the 2 bolts and the No. 3 side step bracket.

